

LSN-20-XX-U-II

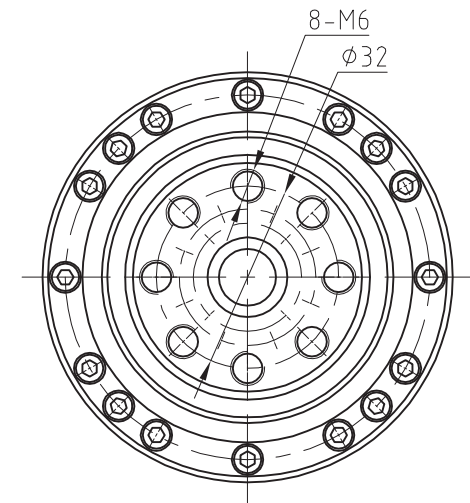
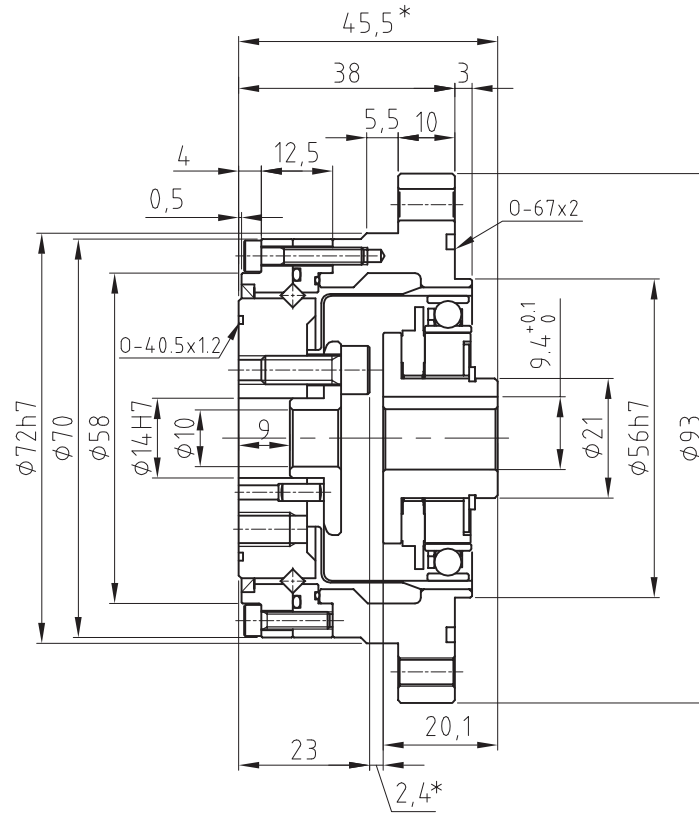
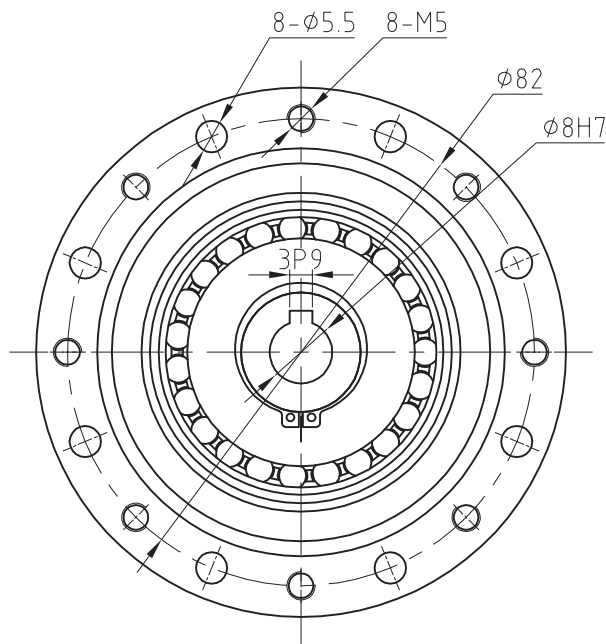

| Model | Reduction ratio | Rated torque at 2000r/min input | | Permissible peak torque at start and stop | | Permissible maximum value for average load torque | | Permissible maximum momentary torque | | Permissible maximum input rotational speed (Grease) | Permissible average input rotational speed (Grease) | Backlash | Desian life |
|-------|-----------------|---------------------------------|------|---|------|---|------|--------------------------------------|------|---|---|----------|-------------|
| | | Nm | kgfm | Nm | kgfm | Nm | kgfm | Nm | kgfm | | | | |
| 20 | 50 | 25 | 2.5 | 56 | 5.7 | 34 | 3.5 | 98 | 10 | 6500 | 3500 | ≤20 | 10000 |
| | 80 | 34 | 3.5 | 74 | 7.5 | 47 | 4.8 | 127 | 13 | | | | 15000 |
| | 100 | 40 | 4.1 | 82 | 8.4 | 49 | 5.0 | 147 | 15 | | | | 15000 |
| | 120 | 40 | 4.1 | 87 | 8.9 | 49 | 5.0 | 147 | 15 | | | | 15000 |
| | 160 | 40 | 4.1 | 92 | 9.4 | 49 | 5.0 | 147 | 15 | | | | 15000 |

Technical Requirements:

- 1.Please use the grease specified by our company (LF-2 or F-3).
- 2.The * in the drawing is the installation reference size, please follow the installation size requirements.
- 3.For details of size, please confirm with the delivery specification drawings.